



Toi MAHARA Shop Space: Expression of Interest Terms & Conditions

- 1) Work is accepted in the retail area on a sale-or-return basis on consignment and remains the property of the artist until it is sold.
- 2) Arrival or collection of stock will be arranged with the gallery staff and/or Director during retail hours (Tuesday–Sunday, 10am–4pm)
- 3) Should an item be damaged, lost or stolen while it is in the safe keeping of the gallery, the gallery will reimburse the artist for its loss to the value of the stated artist price of the work.
- 4) Commission

Artists must advise Toi MAHARA of the artist price for any item which will be sold through the retail area. Toi MAHARA adds a markup of 50% plus GST on the artist price (equivalent of a commission of 33.33%)

- 5) Pricing

The artist may either state the price they would like their item to retail at (inclusive of our commission) or the artist's price: what the artist would receive for a sold item with Toi MAHARA then adding the commission and GST to each item.

- 6) Payment

Due to the small operation in the retail area and part-time nature of administrative staff, Toi MAHARA is unable to process sales daily. Artist's will be reimbursed once a month.

- 7) Record Keeping

Stock will be entered into the gallery stock system and stock takes will be conducted periodically.

- 8) Storing Work

Due to space constraints Toi MAHARA is unable store artist's work.

Display specifications

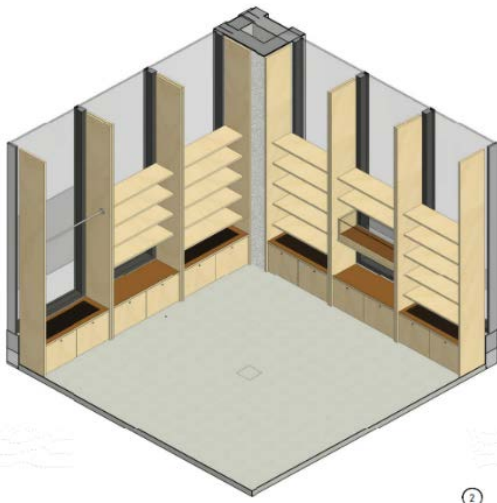

RETAIL SHELVES

Any proposed items will need to fit within the following dimensions:

- Shelf width: variable from 1000mm to 1100mm
- Shelf height: adjustable from 300mm to 500mm
- Shelf depth: 300mm

POSTER BIN

Maximum dimensions of work (unframed) proposed for the 'poster bin'.

(Box is 950mm wide x 500mm deep and an internal height of 650mm)

- A0 size (or equivalent)

Minimum dimensions of work (unframed) for the 'poster bin'

- A3 Size (or equivalent)

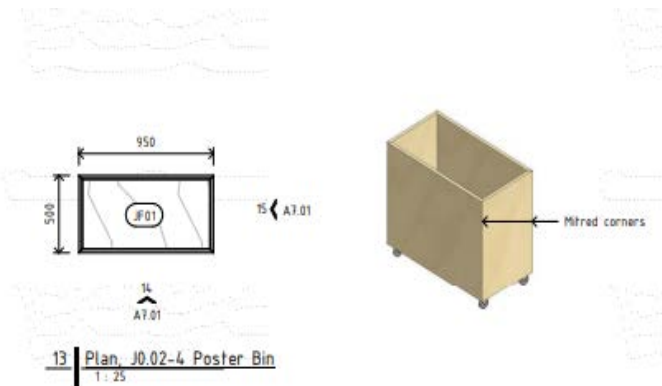

JEWELLERY DISPLAY BOXES

There are two displays:

- one in the reception desk (700x600mm)
- the other in one of the retail windows (300x1000mm)

